



ChipBrand



One BIN only  
for a CCT range



Lifetime



Certified



Certified



Warranty

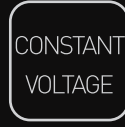

Certified



Certified

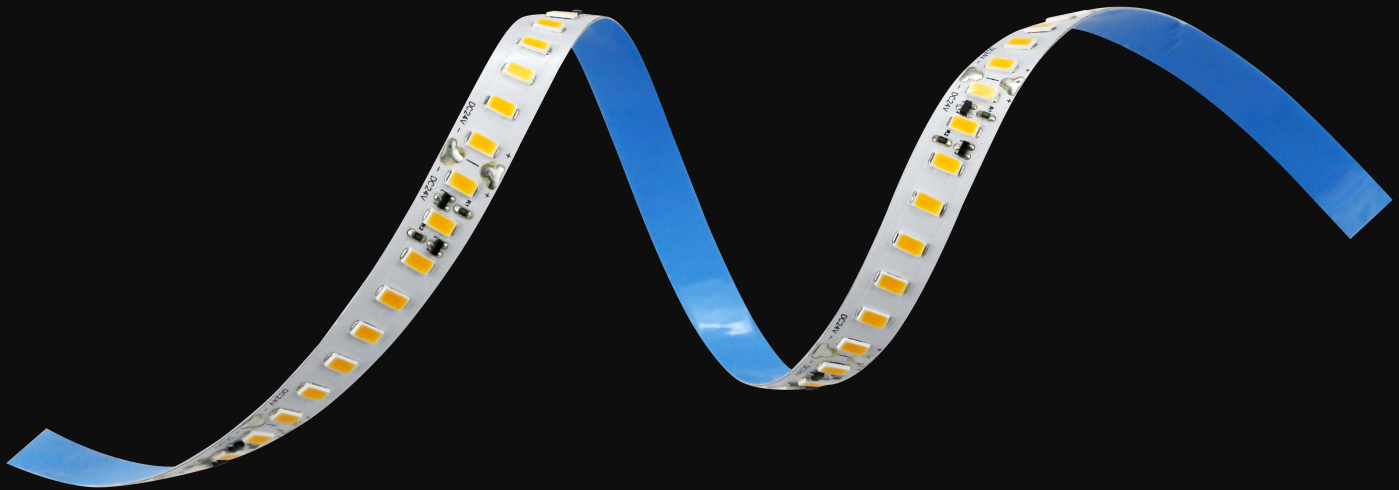

### Ra Available



### IP Grade Available



### Features

- High Light Efficacy
- Constant Voltage 24 VDC system
- Silicone extruded-IP68, Silicone tube encased-IP67, Silicone coated-IP65, indoor-IP22 available
- Epistar chips, LM80 tested
- Ra80+
- CE and RoHS certified
- 3 years warranty







#### BLUEVIEW ELEC-OPTIC TECH CO.,LTD

Tel: +86-28-8148 0011      Fax: +86-28-8148 1258  
 Mail: sales@blueviewled.com      Web.: www.blueviewled.com  
 Add: No.1000, Section 2, 2nd Konggang Road, Southwest  
 Aviation Industrial Development Zone, Chengdu, Sichuan, China.  
 Zip code: 610207

Specifications are subject to change without notice.  
 © Blueview™ 2017 – All rights reserved. Made in China.

### Specifications

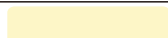
<b>LED Type</b>	SMD 5730	<b>Dimmable</b>	Yes (compatible with BV311 RF dimmer & BV Dimmer)
<b>LED Q'ty/m</b>	128pcs	<b>IP grade</b>	IP22 (IP65 & IP67 & IP68 available upon request)
<b>Input Voltage</b>	24V DC	<b>Installation</b>	Heat-conductive adhesive tape (Heat sink is necessary)
<b>Power</b>	23.04±10%W/m	<b>Working Temperature</b>	-25~+60°C
<b>Cutting length</b>	62.5mm, 8 LEDs	<b>Max run</b>	6.5 meters (Single Feed)
<b>Strip Width</b>	10mm	<b>Certification</b>	CE, RoHS
<b>Viewing Angle</b>	120°	<b>Warranty</b>	3 years

Order Code	CCT/Color	Ra	Lumen/M <sup>2</sup>
CN-H5730-128-24-27K	 2700K	80+	2660
CN-H5730-128-24-30K	 3000K	80+	2691
CN-H5730-128-24-35K	 3500K	80+	2700
CN-H5730-128-24-40K	 4000K	80+	2727
CN-H5730-128-24-50K	 5000K	80+	2780
CN-H5730-128-24-65K	 6500K	80+	2800

Note<sup>Ⓔ</sup>: The output power must be 24V. Neither higher nor less than 24V to avoid wattage affection to the strip light.

Note<sup>Ⓔ</sup>: Lumen output are measured according to PMS-80, with a tolerance of +/- 5%

Note<sup>Ⓔ</sup>: Standard package: 5m/roll

### Order Code

Model	Quality level	LED Q'ty/M	Input voltage	CCT/Color
<b>CN</b>	<b>H5730</b>	<b>128</b>	<b>24</b>	<b>27K</b>
CN-IP22 CWS-IP65 CWT-IP67 CWE-IP68	H5730-3 yrs warranty		24V DC	view table above for options

### BLUEVIEW ELEC-OPTIC TECH CO.,LTD

Tel: +86-28-8148 0011      Fax: +86-28-8148 1258  
 Mail: sales@blueviewled.com      Web.: www.blueviewled.com  
 Add: No.1000, Section 2, 2nd Konggang Road, Southwest  
 Aviation Industrial Development Zone, Chengdu, Sichuan, China.  
 Zip code: 610207

Specifications are subject to change without notice.  
 ©Blueview™ 2017 – All rights reserved. Made in China.

### Dimension

Unit:mm[in]



### Package

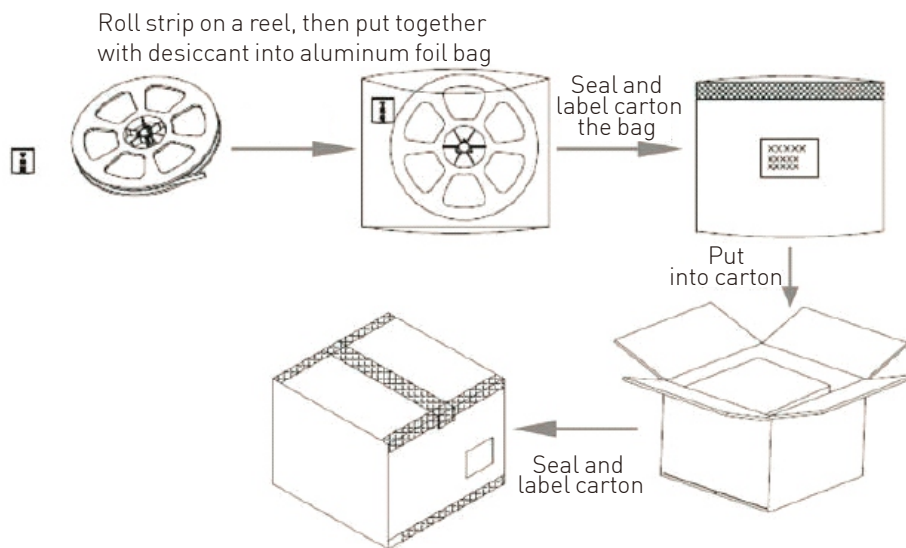

#### Packing Info

Order Code	Net Weight / CTN	Gross Weight / CTN	Units / CTN	Carton Size
CN-H5730A-128-24	9.55(1±10%) kg	14.05(1±10%) kg	100 rolls	550*400*340mm

#### BLUEVIEW ELEC-OPTIC TECH CO.,LTD

Tel: +86-28-8148 0011      Fax: +86-28-8148 1258  
 Mail: sales@blueviewled.com      Web.: www.blueviewled.com  
 Add: No.1000, Section 2, 2nd Konggang Road, Southwest  
 Aviation Industrial Development Zone, Chengdu,Sichuan, China.  
 Zip code: 610207

Specifications are subject to change without notice.  
 ©Blueview™ 2017 – All rights reserved. Made in China.